

# Core / Cup Plugs

Mercury Products offers stainless and Sealrite core/cup plugs in a variety of materials and finishes to improve reliability and reduce part costs.



## Applications

For automotive and non-automotive:

- Gasoline and diesel engines
- Transmissions
- Transfer cases
- Gear boxes, etc.

## Materials

Cold-rolled, brass, stainless steel, aluminum, or other upon your request.

## Sizes

Standard diameters range from 1/2" to more than 3 1/4" or custom, per your application requirements.

## Finishes

Zinc-plated or other upon your request.



**About Mercury Products** Manufacturers around the world count on us for custom and innovative metal products and assemblies, and have since 1946. Mercury has the resources, flexibility and expertise to handle even the most demanding projects. Our customers have a strategic partner for every step of the process, from engineering and design through testing and manufacturing, because we align our capabilities with their goals. With our products ultimately used for securing and serving the heavy truck, construction, agricultural, automotive and motorcycle market vehicles in addition to industrial, exhaust and other market products, we like to think we help hold the world together!

**MERCURY PRODUCTS™**  
ENGINEERED FABRICATIONS & ASSEMBLIES

Core/Cup Plug Facility:  
439 Jutras Drive South  
Windsor, Ontario, Canada N8N5C4  
info@mercprod.com

Certifications:  
ISO9001 | ISO/TS16949 | ISO14001  
See our website for more information.

# Core / Cup Plugs Specifications

## Stainless Core / Cup Plugs (measurement in inches)

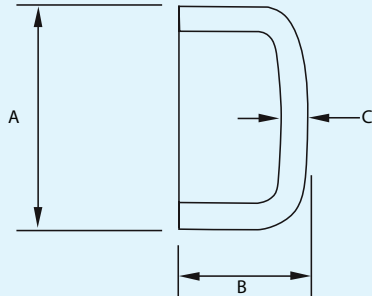

Reference #	"A"		"B"		"C"
	Minimum Diameter (O.D.)	Maximum Diameter (O.D.)	Minimum Height	Maximum Height	Material Gauge (Min / Max)
SS0001	0.4120	0.4150	0.1780	0.1980	.039 / .045
SS0004	0.4961	0.4984	0.1660	0.1860	.037 / .043
SS0007	0.5440	0.5470	0.1810	0.2300	.038 / .042
SS0012	0.6360	0.6390	0.2400	0.2800	.039 / .045
SS0016	0.7598	0.7618	0.2300	0.2700	.045 / .053
SS0022	0.8250	0.8280	0.2400	0.2800	.047 / .053
SS0026	0.9160	0.9190	0.2000	0.2300	.045 / .055
SS0031	1.0120	1.0160	0.3000	0.3400	.047 / .053
SS0033	1.1310	1.1330	0.2400	0.2800	.045 / .055
SS0037	1.2620	1.2660	0.3000	0.3400	.050 / .060
SS0041	1.3870	1.3900	0.2910	0.3380	.054 / .061
SS0044	1.5060	1.5090	0.2910	0.3400	.054 / .062
SS0050	1.6450	1.6490	0.3500	0.3900	.055 / .065
SS0053	1.7630	1.7680	0.3400	0.3800	.055 / .065
SS0055	1.8890	1.8930	0.3500	0.3900	.057 / .063
SS0059	2.1380	2.1430	0.3500	0.3900	.057 / .063
SS0064	3.3120	3.3150	0.2100	0.2500	.025 / .045

Note: More sizes available

## Sealrite Core / Cup Plugs (measurement in inches)

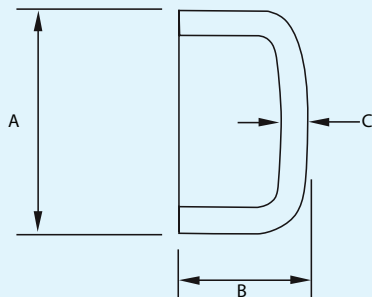

Reference #	"A"		"B"		"C"
	Minimum Diameter (O.D.)	Maximum Diameter (O.D.)	Minimum Height	Maximum Height	Material Gauge (Min / Max)
CR0001	0.1970	0.1990	0.1050	0.1450	.020 / .040
CR0002	0.2580	0.2600	0.1640	0.2040	.037 / .045
CR0004	0.3150	0.3189	0.1693	0.2080	.037 / .042
CR0009	0.4400	0.4420	0.1680	0.2080	.036 / .043
CR0012	0.5098	0.5138	0.2300	0.2700	.034 / .046
CR0018	0.6265	0.6285	0.1800	0.2000	.025 / .035
CR0023	0.7150	0.7170	0.2260	0.2460	.034 / .042
CR0029	0.8228	0.8252	0.2300	0.2700	.045 / .051
CR0033	0.9350	0.9370	0.2500	0.2900	.045 / .053
CR0039	1.1109	1.1143	0.3250	0.3830	.059 / .069
CR0043	1.2565	1.2585	0.3000	0.3200	.055 / .060
CR0046	1.3240	1.3260	0.3000	0.3200	.055 / .060
CR0048	1.4150	1.4170	0.3970	0.4370	.057 / .065
CR0049	1.5060	1.5080	0.2910	0.3400	.055 / .060
CR0053	1.6970	1.6990	0.3500	0.3700	.055 / .060
CR0054	1.7510	1.7545	0.5300	0.6000	.055 / .060
CR0055	1.8230	1.8250	0.3400	0.3800	.053 / .063
CR0057	2.1040	2.1070	0.2360	0.2760	.057 / .063
CR0064	2.5720	2.5750	0.3800	0.4400	.065 / .073
CR0067	3.5050	3.5100	0.3600	0.4000	.045 / .051
CR0068	4.8370	4.8512	0.6020	0.6500	.111 / .120

Note: More sizes available