

Accumulator Brackets

Mercury Products offers a comprehensive variety of accumulator brackets for a complete range of diameters and designs.



Applications

For heavy truck, bus, RV, agricultural and construction equipment, including hydraulic reservoirs.

Materials

Hot-rolled or cold-rolled 1008/1010 steel, stainless steel, aluminized stainless or other upon your request.

Sizes

Standard diameters range from 2½" to over 6" or custom, per your application requirements.

Assemblies

Weldments, with or without hardware.

Finishes

Zinc-plated, chrome-plated, high-heat paint, polished stainless or other upon your request.



About Mercury Products Manufacturers around the world count on us for custom and innovative metal products and assemblies, and have since 1946. Mercury has the resources, flexibility and expertise to handle even the most demanding projects. Our customers have a strategic partner for every step of the process, from engineering and design through testing and manufacturing, because we align our capabilities with their goals. With our products ultimately used for securing and serving the heavy truck, construction, agricultural, automotive and motorcycle market vehicles in addition to industrial, exhaust and other market products, we like to think we help hold the world together!



1201 South Mercury Drive
Schaumburg, Illinois 60193-3598
info@mercprod.com

Certifications:
ISO9001 | ISO/TS16949 | ISO14001
See our website for more information.

Accumulator Brackets Specifications

Heavy-Duty Clamp, Type I

TORQUE TO 20 Nm (15 LB-FT)

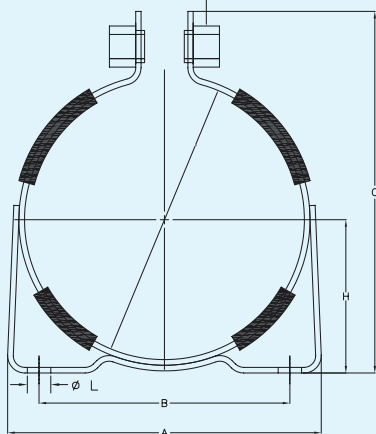

Part No.	Metric	D. NOM	A	B	C REF.	H	L	Width
T1-108	108mm	4.25	5.43	3.94	5.91	2.52	0.35	1.25
T1-114	114mm	4.49	5.35	3.94	6.50	2.87	0.35	1.25
T1-126	126mm	4.96	6.89	5.35	6.89	3.03	0.35	1.25
T1-146	146mm	5.75	6.69	5.35	7.52	3.27	0.35	1.25
T1-167	167mm	6.57	7.28	6.02	8.31	3.64	0.35	1.25
T1-175	175mm	6.89	7.60	6.30	8.74	3.92	0.35	1.25
T1-222	222mm	8.74	10.00	8.50	10.74	4.72	0.35	1.25

Double-Bolt Heavy-Duty Clamp, Type II

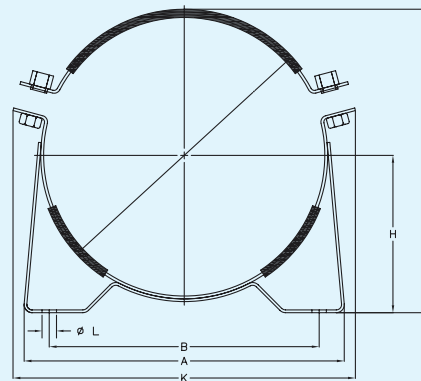

Part No.	Metric	D. NOM	A	B	C REF.	H	K REF.	L	Width
T2-206	206mm	8.11	10.24	8.19	9.06	4.65	10.83	0.59	1.25
T2-213	213mm	8.39	10.63	8.50	9.37	4.84	11.22	0.59	1.25
T2-219	219mm	8.62	10.55	8.50	9.45	4.84	11.22	0.59	1.25
T2-226	226mm	8.90	10.63	8.50	9.61	4.84	11.61	0.59	1.25
T2-242	242mm	9.53	10.55	8.50	10.43	5.35	12.00	0.59	1.25
T2-286	286mm	11.26	13.07	11.02	12.36	6.42	13.98	0.59	1.25
T2-310	310mm	12.20	13.07	11.02	13.11	6.69	14.96	0.59	1.25
T2-360	360mm	14.17	16.81	14.37	15.08	7.68	16.69	0.59	1.25

Medium-Duty Clamp, Type III

TORQUE TO 10 Nm (7 LB-FT)

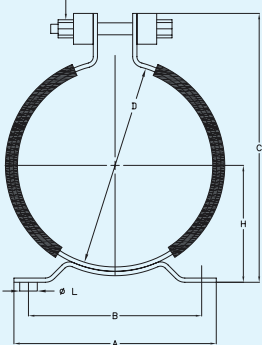

Part No.	Metric	D. NOM	A	B	C REF.	H	K REF.	Width	Thickness
T3-64	64mm	2.52	4.06	3.35	3.78	1.57	0.33	0.88	0.12
T3-74	74mm	2.91	4.06	3.35	4.13	1.77	0.33	0.88	0.12
T3-91	91mm	3.58	4.65	3.94	4.80	2.09	0.33	0.88	0.12
T3-105	105mm	4.13	5.04	4.33	5.35	2.36	0.33	0.88	0.12
T3-115	115mm	4.53	5.04	4.33	5.75	2.56	0.33	0.88	0.12
T3-121	121mm	4.76	5.04	4.33	5.98	2.68	0.33	0.88	0.12
T3-136	136mm	5.35	5.63	4.92	6.89	3.23	0.33	0.88	0.12
T3-145	145mm	5.71	5.63	4.92	7.17	3.39	0.33	0.88	0.12
T3-152	152mm	5.98	6.69	5.98	7.24	3.31	0.33	0.88	0.12
T3-160	160mm	6.30	6.69	5.98	7.68	3.43	0.33	0.88	0.12

Light-Duty Hydraulic Series, Type IV

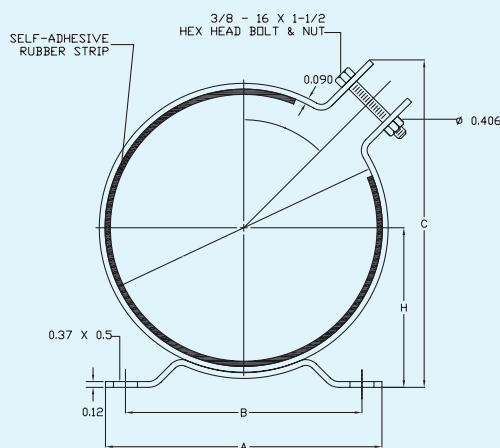

Part No.	D. NOM	A	B	C REF.	H	Width	E
T4-64	2.62	5.00	3.94	3.75	1.66	1.25	As Specified
T4-86	3.38	5.00	3.94	4.48	2.10	1.25	As Specified
T4-102	4.00	7.00	6.30	5.03	2.41	1.25	As Specified
T4-121	4.75	7.00	6.30	5.70	2.78	1.25	As Specified
T4-127	5.00	7.00	6.30	5.92	2.91	1.25	As Specified